



P.O. Box 293, Fall City, WA 98024 historylives@fallcityhistorical.org www.fallcityhistorical.org

Is It A Trail Or A Road?

It started with the railroad. In 1889, the Seattle, Lakeshore and Eastern Railroad tracks passed near Fall City, and a depot was constructed at the current site of the Preston-Snoqualmie Trail parking lot on Lake Alice Rd. In 1889, Doc Taylor petitioned King County to have a road built to improve access to the depot. No maps of this road are available, but it is recorded as County Road #234. The original entrance to what is now Lake Alice Rd was behind the cemetery, along with the later-built David Powell Rd. In 1964, the County approved plans for the Lake Alice Road Connection, moving the entrance further down Preston-Fall City Rd, and creating what is now SE 47th St. The old portion of the paved road behind the cemetery now serves as a trail for walking and biking from David Powell Rd.



Waiting for the train excursion at the depot located on the road to Lake Alice. Dated 1890
Credit: Snoqualmie Valley History Museum

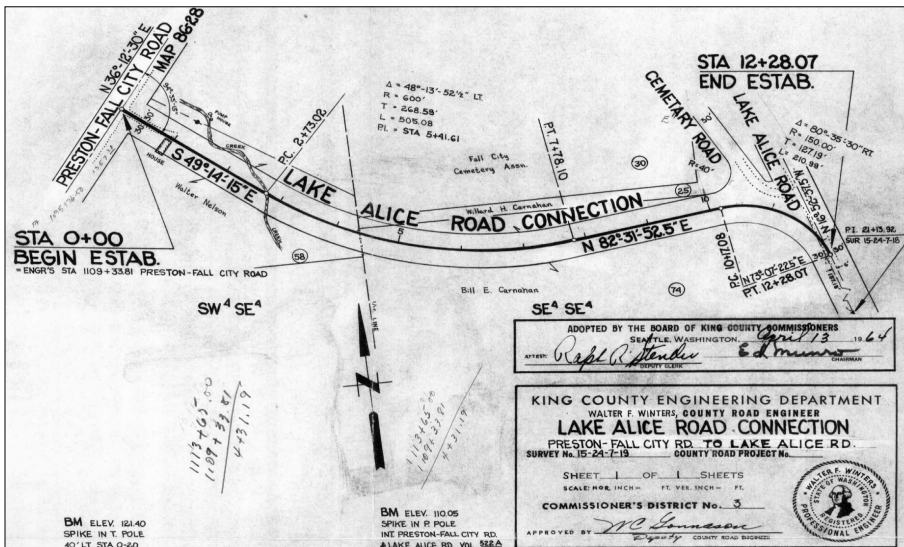

1964 King County Road Plans for Lake Alice Road Connection



Old paved road, now a trail

Join us at THE POP UP MUSEUM GALA March 31, 2026 6:30pm

Our 2026 Pop Up Museum opens with the Gala, and runs through the Sat., April 11, 2pm. Hours April 1 - April 10 are Noon - Closing at the Fall City Library. This year we will feature the United Methodist Church, Fall City Day through the years, the Stevens Family Market, and hands-on activities with "What Is It" and crafts.

Support for our work from King County Heritage 4Culture is gratefully acknowledged.

